



41 Jubilee Close, Salisbury, Wiltshire, SP2 9HF

£275,000 Freehold

A modern, three bedroom end of terrace house on the western outskirts of the city. The property benefits from PVCu double glazing, gas fired central heating a garage and rear garden. NO ONWARD CHAIN.

Directions

From our office in Castle Street proceed away from the city centre and at the roundabout turn left on to the ring road. At the next roundabout continue forwards on to the A36 Wilton Road and after the traffic lights at Skew Bridge turn right. Turn immediately left at the mini roundabout into Pembroke Road before taking the next left hand turn to continue on Pembroke Road. Take the next right into Festival Avenue and the next right again into Jubilee Close. The property can be found immediately on the right hand side.

Description

The property is a well proportioned three bedroom end of terrace house situated within this modern development on the western side of the city. Offered with no onward chain, the accommodation comprises an entrance hallway, a cloakroom and a kitchen with a good range of units with an integrated oven and hob. There is an L-shaped sitting/dining room with French doors leading out on to the rear garden which has a southerly aspect. On the first floor are three bedrooms, with the main bedroom having a good range of built-in wardrobes and there is a family bathroom. Further benefits include PVCu double glazing and gas fired central heating. The property has been fully recarpeted and redecorated and is in excellent order. There is a rear garden and a single garage in a block behind the property. Jubilee Close is a quiet and established location near to schools and convenience stores and is situated approximately one mile from the city centre which has an excellent range of amenities including a mainline railway station serving London Waterloo.

Property Specifics

The accommodation is arranged as follows, all measurements being approximate:

Entrance hall

Part glazed front door, stairs with cupboard under, wall mounted thermostat, radiator.

Cloakroom

Fitted with a white suite comprising low level WC, wash hand basin, radiator, obscure glazed window to front, electric fusebox, laminate floor.

Sitting/dining room 17'0" x 15'11" both max (5.20m x 4.87m both max)

Window to rear, French doors to rear, TV point, telephone point, two radiators, space for table and chairs.

Kitchen 9'2" x 7'8" (2.81m x 2.36m)

Fitted with base and wall units with roll top work surfaces and tiled splashbacks, integrated electric oven with four ring gas hob and extractor over, space for fridge/freezer, space/plumbing for washing machine, sink and drainer with mixer tap under window to front.

Stairs to first floor - Landing

Access to loft.

Bedroom one 13'10" x 10'4" both max (4.24m x 3.16m both max)

Two windows to rear, built in wardrobes, radiator.

Bedroom two 11'5" x 8'5" both max (3.50m x 2.57m both max)

Window to front, cupboard housing gas boiler and shelving.

Bedroom three 10'11" x 7'3" (3.33m x 2.22m)

Window to front, radiator.

Bathroom

Fitted with a white suite comprising low level WC, pedestal wash hand basin, panelled bath with shower screen, inset spotlights, extractor, laminate floor, radiator, shaver point, obscure glazed window to side.

Outside

To the rear of the house is a patio with a lawned and enclosed garden with a useful side gate. Behind the house is a single garage in a block (the garage nearest the house) with an up and over door.

Services

Mains gas, water, electricity and drainage are connected to the property.

Outgoings

The Council Tax Band is 'C' and the payment for the year 2022/2023 payable to Wiltshire Council is £1,873.56.

Ground Floor

Approx. 37.5 sq. metres (404.1 sq. feet)

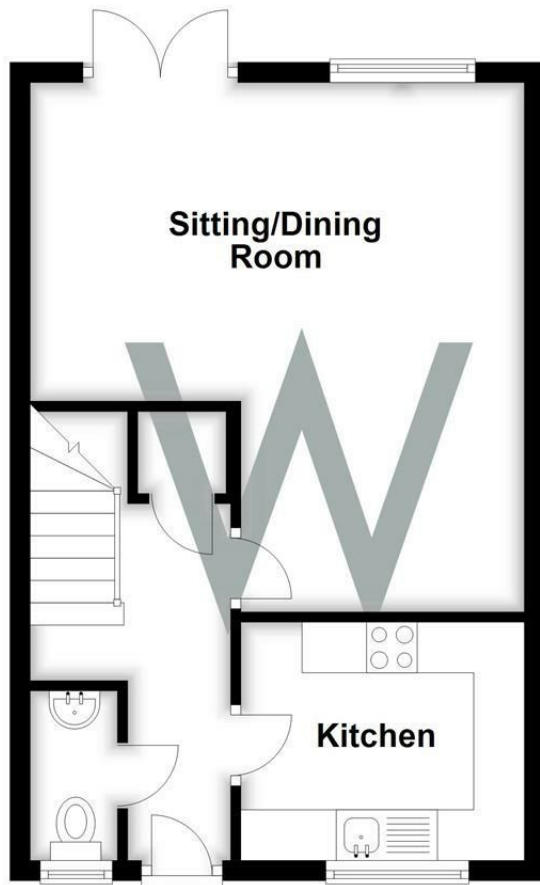

First Floor

Approx. 37.5 sq. metres (404.1 sq. feet)

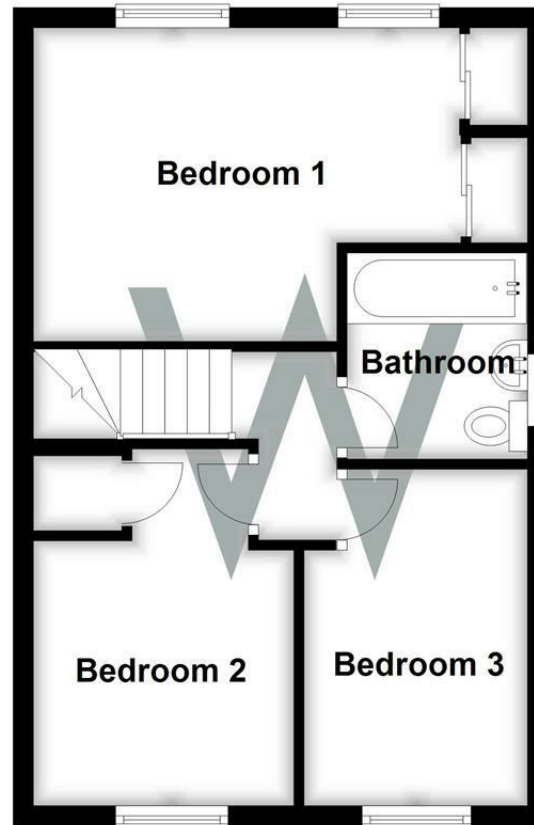

Total area: approx. 75.1 sq. metres (808.2 sq. feet)

WHITES

Castle Chambers, 47 Castle Street,
Salisbury, Wiltshire, SP1 3SP

01722 336422

www.hwwhite.co.uk

residential-sales@hwwhite.co.uk



